

MedProtocol



# INTERNATIONAL SWIMMING LEAGUE PREVENTION- AND INTERVENTION PROTOCOL

(hereinafter: Protocol)

## I. DEFINITIONS

1. **Bubble:** an umbrella term for the Training Location, the Competition Venue, the Hotel and the buses involved in the transportation of the Teams. Due to the Protocol's epidemiological provisions, the probability of a COVID-19 infection is very low within this Bubble;
2. **CMO:** Chief Medical Officer, the head of the Medical Team;
3. **COVID-19:** an infection and disease caused by the coronavirus SARS-CoV-2;
4. **COVID Marshal:** a Hungarian healthcare or other professional appointed by the Hosting Committee, who attended an epidemiologic training or briefing held by the epidemiologic experts of the Semmelweis University, and who - as part of the Medical Team - are responsible for enforcement of this Protocol.
5. **Team:** a formation of Competitors established in line with the rules of the Tournament;
6. **Training Location:** Duna Arena and Dagály Thermal Bath and Swimming Pool;
7. **Healthcare Provider:** a Hungarian or foreign healthcare staff member, a physician or physio-therapist with a qualification in healthcare;
8. **Deputy CMO:** The deputy of the CMO;
9. **ISL:** International Swimming League;
10. **ISL's Hungarian Representative:** a member or an agent of ISL's Hungarian Hosting Committee;
11. **Epidemiological isolation:** isolation of communicable disease patients from healthy population at the person's residence or in an in-patient healthcare institute;
12. **Quarantine:** an epidemiological monitoring process, wherein, to prevent any transmission of COVID-19 infection, persons not showing symptoms but potentially infected are isolated or the movement of such persons is restricted at their place of (temporary) residence or in an in-patient healthcare institute for the period until lack of COVID-19 infection is proven;
13. **Foreign Participant:** non-Hungarian citizens with an eligibility defined by the Hosting Committee, who
  - a) are participants of the Tournament (spectators excluded)
  - b) and are in possession of an invitation letter addressed to them and issued by the ISL.
  - c) has arrived to the Tournament upon the invitation of a Hungarian sports association or a nationwide sports discipline association
    - ca) ca) a competitor in possession of a competition license,
    - cb) a sports expert, or
    - cc) persons contributing to the conduct of the sports event;



14. **Foreign Competitor:** persons under I. 13. c) ca).
15. **Hungarian Participant:** Hungarian citizens with an eligibility defined by the Hosting Committee, who
  - a) are participants of the Tournament (spectators excluded)
  - b) and are in possession of an invitation letter addressed to them and issued by the ISL.
  - c) with regard to the Tournament
    - ca) a competitor in possession of a competition license,
    - cb) a sports expert, or
    - cc) persons contributing to the conduct of the sports event;
16. **Hungarian Competitor:** persons under I. 15. c) ca).
17. **Medical Team:** a team comprising of healthcare and other professionals who provide the overall healthcare support of the Tournament and activities preventing the spread of COVID-19 infection;
18. **NCPH (NNK):** National Center for Public Health;
19. **Pre-triage:** a test upon entering the Bubble;
20. **Participant:** persons under I. 13. and 15.;
21. **RTP Test:** Return to Play, verification of the health fitness of Competitors to participate in the Tournament;
22. **SARS-CoV-2 PCR Test:** a molecular biological examination to detect COVID-19 infection conducted using naso-pharyngeal and oropharyngeal samples, in line with the healthcare service rules;
23. **SU:** Semmelweis University
24. **SU's Epidemiology Expert:** The Epidemiology Inspector staff of Semmelweis University's Hospital Hygiene Department;
25. **Hotel:** Thermal Margitsziget Health Spa Hotel, Grand Hotel Margitsziget and Danubius Hotel Helia;
26. **Hotel staff:** staff who come into contact with the Competitor, perform tasks at the Hotel reception or participate in restaurant services;
27. **Personal Protective Equipment:** any equipment with the intended use of mitigation of the risk of transmission of infections to the extent where the risk of such infection no longer endangers human health, particularly wearing a face mask;
28. **Hosting Committee:** the Hosting Committee of the ISL;
29. **Close Contact:** persons who
  - a) have been in close physical or personal contact with a COVID-19 case;
  - b) persons who simultaneously stayed in the same, enclosed room within 2 (two) meters for at least 15 minutes;
30. **Competition Venue:** Duna Arena;
31. **Tournament:** a swimming tournament organized by ISL in Budapest through October, November & December 2020;
32. **Competitor:** persons under I. 14. and 16.

---

## II. GENERAL PROVISIONS CONCERNING THE TOURNAMENT

---

1. Approximately 750 (seven hundred and fifty) people, from 40-45 (forty to forty-five) countries will arrive to Budapest for the Tournament. A smaller proportion of the Foreign Participants will arrive between October 8-9, 2020, while the majority of them, altogether 650 people will do so on October 11 and 19, 2020. Almost all foreign participants will leave on 23 November 2020.
2. The number of Hungarian participants is approximately 600 (six hundred).
3. The Tournament is hosted by the Duna Arena, while preparation is served by the 50 (fifty) meter pool (to be covered) of Dagály Thermal Bath and Swimming Pool.

### III. STRATEGIC ELEMENTS OF THE PREVENTION OF THE SPREAD OF COVID-19

1. Participants' protection against COVID-19 is served by 2 (two) consecutive lines of defense.
  - a) The Protocol's preventive measures constitute to the primary line of defense. In this phase, the Training Location, the Competition Venue, the Hotel and the bus involved in the transportation of the Team are placed in the Bubble. For participants, entry to the territory of the Bubble is subject to a negative SARS-CoV-2 PCR test. Upon each entry to the Bubble, participants are subjected to a pre-triage check under Clause X of the Protocol. Controlled access to the Bubble through pre-triage screening and SARS-CoV-2 PCR tests significantly reduces the chance for COVID-19 infections to appear within the Bubble.
  - b) Should any Participant test positive in the SARS-CoV-2 PCR test, as a secondary line of defense, the procedures under Clauses XI-XIII of the Protocol will be applied to prevent further spread of the COVID-19 infection.
    - i. The Medical Team separates and monitors the infected person and all Close Contacts;
    - ii. The infected Participant will follow the procedure under Clause XIV within the Bubble to reduce the number of Close Contacts.
2. To ensure adherence to the Protocol, the Hosting Committee will sanction any violations as per the ISL's protocol. The Medical Team will oversee adherence to the Protocol.
3. In case of non-compliance with the provisions of the Protocol and the Hungarian epidemiological provisions resulting in aggravation of the epidemiological situation, the Government of Hungary, in consultation with the ISL, may apply sanctions other than those specified in point 2, including re-consideration of the Tournament.
4. Should a mass COVID-19 infection or mass quarantine occur within the community of Competitors, this may cause that the number of Teams will not be sufficient to conduct the Tournament or some elements thereof. In such cases, the Hosting Committee's pertinent protocol shall be applied.

### IV. PROTOCOL BEFORE ENTRY IN THE COUNTRY

1. The Protocol shall be sent to all Foreign Participants prior to departure in the English language. For Hungarian Participants, the Protocol shall be sent in the Hungarian language with the timing that allows familiarization with its content in time.
2. An Agreement shall be signed with Participant causing him/her to adhere to the testing/quarantine measures. For Foreign Participant, this Agreement shall include provisions for healthcare insurance.
3. All Participants shall fill in a questionnaire concerning their COVID-19 anamnestic data. The questionnaire may not be older than 48 (forty-eight) hours before arrival. The questionnaire shall be sent to the CMO online.
4. Foreign Participants' SARS-CoV-2 PCR testing obligation before arrival to the country are specified in the provisions of Clause XI.1. and 4.
5. Foreign Participants who are classified being in the high-risk group, e.g. asthma patients or participants who are vulnerable due to their age shall notify the Hosting Committee through the Team of the Foreign Participant to ensure a higher intensity of monitoring.

## V. PROTOCOL UPON ENTRY IN THE COUNTRY

1. Foreign Participants will be subjected to border control.
2. Foreign Participants will collect their baggage.
3. ISL's representatives (for whom, wearing face masks is mandatory) will meet Foreign Participants while keeping social distance.
4. Foreign Participants shall also wear face masks.
5. Foreign Participants will be informed by the COVID Marshal concerning accessing the bus and transportation to the Hotel.
6. Should a Foreign Participant notice symptoms of COVID-19, he/she shall report this to the Medical Team.
7. Foreign Participant shall load their own baggage onto the bus.
8. Foreign Participant will be transported to the designated unit of SU, where it will be subjected to the first SARS-CoV-2 PCR test.
9. Following the procedure under Point 8, Foreign Participant will be transported to the designated Hotel.
10. Foreign Participants shall unload their own baggage from the bus.
11. Upon entering the Hotel, Participant will be subjected to the pre-triage protocol under Clause X of the Protocol.
12. Participants occupy the room reserved for them.

## VI. PROTOCOL REGARDING THE HOTEL

1. The Hotel is reserved exclusively for Participants.
2. Hotel Staff shall also be subjected to the SARS-CoV-2 PCR tests under Clause XI. 9-10.
3. The processes concerning cleaning, laundry and meals shall be conducted using a protocol approved by the Hotel's Certified Expert and SU's Epidemiology Expert.
4. Use of the Hotel rooms is governed by the protocol prepared by SU's Epidemiology Expert.
5. The Hotel rooms are fitted with the following hygiene tools:
  - a) a) disinfectant wipes;
  - b) surface-disinfectants;
  - c) hand sanitizers;
6. At the Hotel's access points, a mandatory pre-triage check will be conducted as per Clause X. of the Protocol.
7. The exclusive accommodation of the Foreign Participant and the person specified in Section I. 15. b) and c) is the Hotel. Foreign Competitors will stay in single rooms, while Foreign Participants - other than Competitors and a person specified in Section I. 15. b) and c) who is not a Hungarian Competitor will be accommodated in a single or double room.
8. Meals are strictly scheduled, and persons are seated apart from each other to comply with the rules of social distancing.
9. The Hotel's room service provides extra supplies, e.g. snacks, energy bars and other competitor- specific supplements.



## VII. PROTOCOL DURING THE STAY IN HUNGARY

1. The Foreign Participant are not under quarantine during the Tournament, and may only move freely in the Bubble and on Margaret Island, excluding enclosed public spaces and entertainment venues, with the occasional period of stay outside of the Bubble being maximum 90 (ninety) minutes. This provision also applies to the Hungarian Competitor and the person specified in Section I. 15. c) cb).
2. A separate conference room is provided for the Teams, where they can conduct their meetings.
3. During the Tournament, an on-call center is set up, through which, SU staff coordinates healthcare services, if necessary.

## VIII. PROTOCOL REGARDING TRAVEL

1. Use of hand-sanitizers is mandatory upon boarding the bus.
2. On the bus, persons shall observe the rules of social distancing.
3. Seats around the driver shall be kept unoccupied.
4. On the bus, everyone must wear face masks, including the driver.
5. Following each trip, the driver must disinfect the passenger area of the bus as per the protocol prepared and approved by the SU.
6. Each Team will have its own designated bus during the Tournament.

## IX. PROTOCOLS OF TRAINING AND COMPETITION VENUES

1. Training- and Competition Venues are exclusively used for the Tournament during the period thereof.
2. Only Participants with an access authorization may enter the Training- and Competition Venues, while adhering to Clause X of the Protocol.
3. No mascots are allowed in the Training- or Competition Venues, no team photographs may be taken, no handshakes, hugs or any other form of close contact is allowed.
4. If necessary, Participants may use the toilets.
5. The movement of Teams is strictly scheduled; all Competitors of the previous Team must leave the Training Location before another Team could enter. The Training Location must be cleaned and disinfected after all Teams, as per a protocol.
6. Equipment used for training must be disinfected after use.
7. In the Pool Area

- a) Competitors must follow the "enter, train, leave" rule;
  - b) Participants' movement routes are pre-defined and allocated to each of them;
  - c) the area around the pool, handrails, handles, seats, benches, changing booths, tables or any other equipment shall be disinfected as per a protocol approved by the SU before the next Team would arrive.
8. Use of the gym of the Training- and Competition Venues is subject to the following rules:
- a) The gym, as the room designated for training - may be used by Competitors, provided that the 4 m<sup>2</sup> (four square meters) rule is observed.
  - b) Other than Competitors, Participants with an access authorization may enter the gym, while adhering to Clause X of the Protocol.
  - c) Prior to entering the gym, the Participant holding an access authorization must listen to an on-site information announcement.
  - d) Hand sanitizing is mandatory upon arrival, change of equipment and upon exiting the room.
  - e) Competitors must clean the equipment after use. For cleaning the equipment used by the Competitor, disinfectant wipes are available.
  - f) Hand-wash stations and hand sanitizers will be placed at certain points in the gym.
  - g) Janitors will clean and disinfect the gym in the time period between vacation by one Team and arrival of the next Team.
9. Toilets, boxes and pools are cleaned by a designated, permanent cleaning personnel.
10. In line with the protocol approved by SU, the toilets, washbasins, doorknobs and handles, along with other equipment is continuously disinfected after each use.
11. Efforts should be put forth to limit the number of Competitor to maximum 5 (five) in each lane of a 10 (ten)-lane pool (50 Competitors). Competitors in neighboring lanes swim in opposite directions, and the coaches stand on opposite ends of the pool.
12. Upon completion of the training session, Competitors return to the designated area, change and exit the pool via the designated route.
13. Competitors exit the Training- and Competition Venue via the designated exit and return to the Hotel.
14. The on-site subdivision of the 1st floor of the Competition Venue, the designated route and directions are shown in a map in Annex 1 to the Protocol; the on-site subdivision of the 2nd floor of the Competition Venue, the designated route and directions are shown in a map in Annex 2 to the Protocol, the on-site subdivision of the Training Location, the designated route and directions are shown in a map in Annex 3 to the Protocol.

---

## X. PRE-TRIAGE CHECK

---

1. Pre-triage checks cover two activities:
  - a) Measurement of body temperature using a contactless thermometer;
  - b) Answering the questions of a questionnaire concerning the person's health condition.
2. Upon each entry to the Bubble, participants are subjected to a pre-triage check.

## XI. SARS-CoV-2 PCR TEST PROTOCOL

1. Foreign Participants shall evidence by two SARS-CoV-2 PCR tests not older than 5 (five) days and taken at least 48 (forty-eight) hours apart and documented in the English or Hungarian languages that at the time of the test, no SARS-CoV-2 coronavirus was present in their system.
2. If due to the distance or the testing protocols of the given country, the test under Point 1 is not feasible, Foreign Participants may enter Hungary, if they evidence by one SARS-CoV-2 PCR test not older 3 (three) days and documented in the English or Hungarian languages that at the time of the test, no SARS-CoV-2 coronavirus was present in their body.
3. Prior to the departure, the Foreign Competitor shall send the results of the SARS-CoV-2 PCR test specified in points 1 and 2 to the Hosting Committee. If this is not possible, he or she must present it at the latest when entering the country.
4. The Foreign Participant shall be subject to epidemiological isolation in the Hotel and the provisions of Section XII shall apply if:
  - a) is unable to present the number of negative SARS-CoV-2 PCR tests specified in points 1 and 2 respectively by the time of crossing the border;
  - b) shows symptoms of COVID-19 despite negative SARS-CoV-2 PCR test results as defined in points 1 and 2;
  - c) is notified of a positive result to the SARS-CoV-2 PCR test in accordance with point 2 or of the 2 (second) result in accordance with point 1, at the latest when crossing the border.
5. Foreign Participants are transported from Budapest Liszt Ferenc International Airport to the SU by a transfer vehicle provided by the Hosting Committee for this purpose, where the 1st SARS-CoV-2 PCR test is conducted. If one SARS-CoV-2 PCR test was performed before entering the country, the SARS-CoV-2 PCR test on arrival will be repeated after 48 hours.
6. SU provides the results of the tests under Point 5 within 12 (twelve) hours.
7. After a negative SARS-CoV-2 PCR test, Foreign Competitors may commence training and may use the gym as per Clause IX. 8.
8. Until the results of the SARS-CoV-2 PCR test conducted in Hungary come back negative, Foreign Participants must remain in quarantine.
9. The Hungarian participant shall be subjected to 2 (two) SARS-CoV-2 PCR tests performed by the staff of the Medical Team designated for this purpose within 5 (five) days before the start of the Tournament, with a difference of at least 48 (forty-eight) hours between samples.
10. SARS-CoV-2 PCR tests concerning Participant will be repeated by the Medical Team's designated team in every 5 (five) days.
11. The Participant is exempted from performing the additional SARS-CoV-2 PCR tests if all of the following conditions are met:
  - a) the Participant certifies with an official document in English or Hungarian that he or she has been confirmed by COVID-19 virus infection by a positive SARS-CoV-2 PCR test within 6 (six) months prior to the start of the Tournament;
  - b) the 2 (two) SARS-CoV-PCR-2 tests performed prior to entering the Bubble are negative;
  - c) The COVID-19 serological IgG test on arrival is positive.
12. In the case of a Participant showing symptoms of COVID-19 despite a negative SARS-CoV-2 PCR test, the procedure set out in Point XII. 5. shall apply.
13. If the Participant's diagnosis is not of COVID-19, the established diagnosis should be followed for general isolation and RTP.
14. If COVID-19 cannot be ruled out, the procedure set out in points XII. 5-8. shall apply.



## XII. PROCEDURES TO FOLLOW FOR POSITIVE SARS-CoV-2 PCR TESTS

1. Should a SARS-CoV-2 PCR test come back positive, the Medical Team shall notify the designated contact person of the NNK.
2. Under the management of the CMO, contacts will be identified.
3. The SARS-CoV-2 PCR test must be repeated on 2 (two) occasions at least 48 (forty-eight) hours apart to rule out false positive results.
4. If the tests under Point 3 come back negative, and the tested person has no symptoms, this person and his/her close contacts may be released from isolation.
5. If the test results under Point 3 proved to be positive,
  - a) the Foreign Participant without symptoms or with mild symptoms will be placed in quarantine in the Hotel, while for Hungarian Participants in their place of (temporary) residence; The quarantine period is 14 days and shall last at least 3 days after the symptoms have disappeared.
  - b) Participants with severe symptoms will be transported to the SU's designated department by the Medical Team for admittance to the hospital.
6. In cases under Point 4 or after being released from the quarantine under Point 5a), the Competitor shall be subjected to RTP tests.
7. If the RTP tests show no deviation, the Competitor may return to the Tournament.
8. If the RTP tests show a pathologic deviation, the Competitor may not return to the Tournament, but may travel home.

## XIII. PROCEDURES CONCERNING CLOSE CONTACTS

1. Close contacts shall be tested with SARS-CoV-2 PCR on the 5th (fifth) and 7th (seventh) day of being in close contact with the positive case.
2. If both of the SARS-CoV-2 PCR tests under Point 1 are negative, the Competitor may return to the Tournament.
3. If any of the SARS-CoV-2 PCR tests under Point 1 comes back positive, the procedure under Clause XII is to be followed.

## XV. HEALTHCARE PROVIDER'S PROTOCOL

1. The Team's Healthcare Provider may
  - a) only treat Competitors within the Team;
  - b) and may not provide healthcare services to other Teams, except for cases where it is pre-coordinated with and authorized by the Hosting Committee;
  - c) use of Personal Protective Equipment is mandatory for consultations held in person;
  - d) where possible, online consultations should be offered to Competitors;
  - e) all healthcare services shall be documented.

## XIV. PROTOCOL CONCERNING CONDUCT AND USE OF PROTECTIVE EQUIPMENT

1. Participants, the Hotel Staff and Health Care Providers shall wear a face mask within or outside the Bubble, except for
  - a) when they are in the dining facility, from starting the meals until they finish it, or when they consume beverages;
  - b) if they stay alone in an enclosed room.
2. Competitor are exempt from wearing a face mask in the gym and in the pool.
3. For Competitors, hand sanitizing is mandatory within the Bubble by using the hand sanitizers placed at disposal there. Competitors are also mandated to often and regularly sanitize hands outside of the Bubble.
4. Social distancing shall mean for Participants at least a distance of 2 (two) meters from each other within the Bubble and from everybody outside of the Bubble.
5. The COVID Marshal is responsible for
  - a) adherence to the Protocol's preventive measures by the Team;
  - b) adherence to the provisions of this Point;
  - c) communication with the CMO or Deputy CMO as needed.

Annex 1 Danube Arena first floor

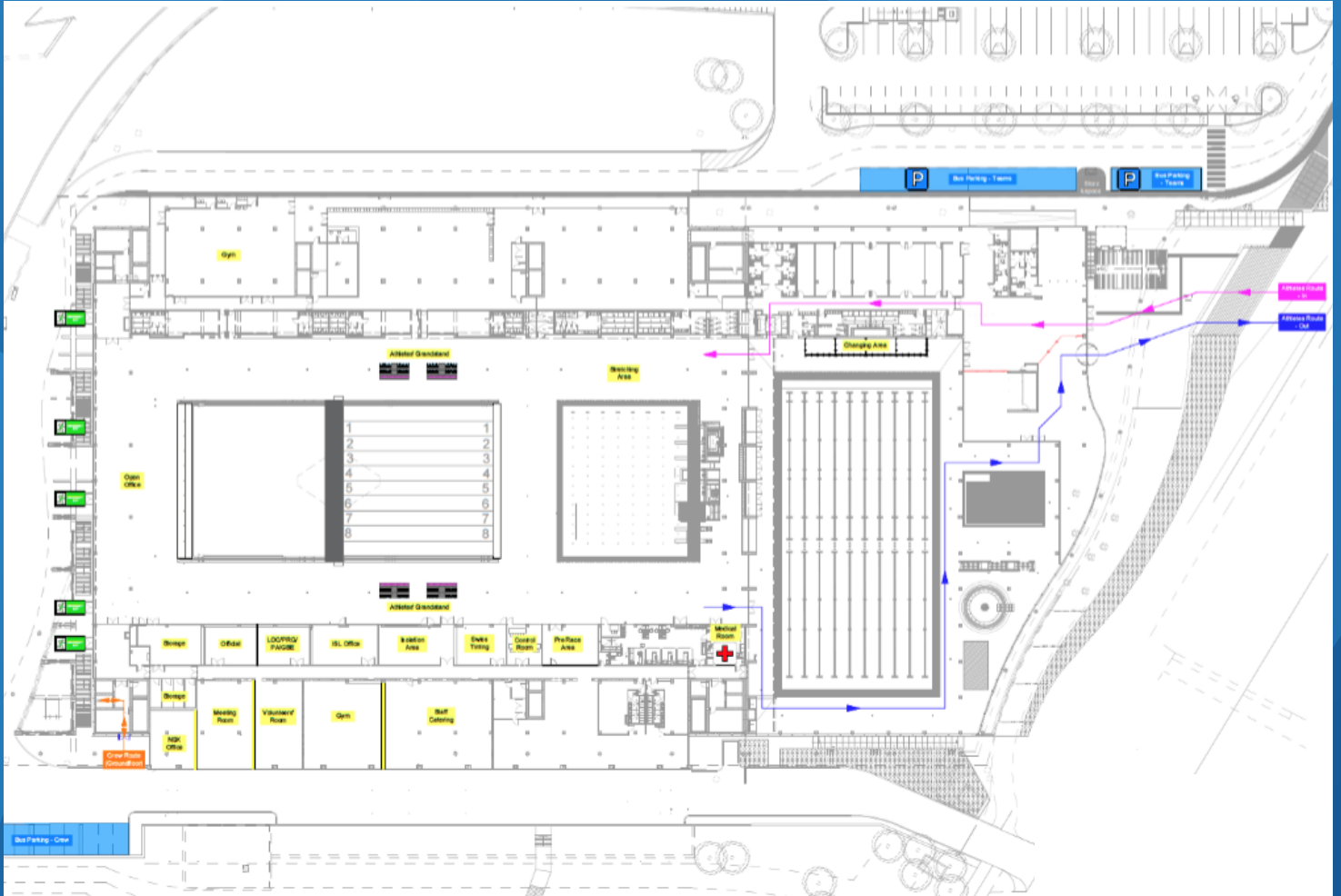

Annex 2 Danube Arena second floor

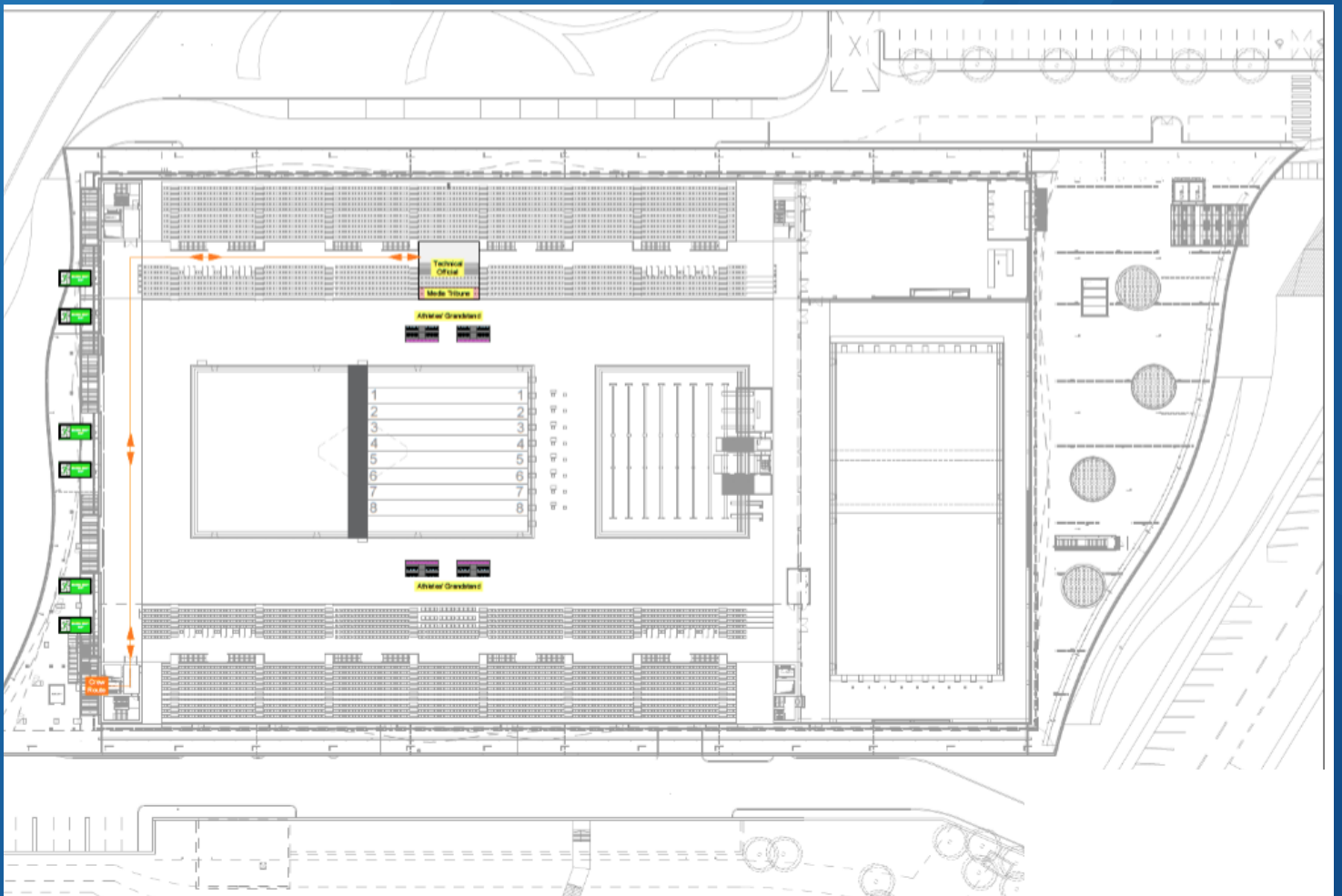



Annex 3 Training Location Dagály Thermal Bath and Swimming Pool



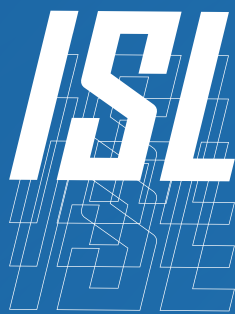

[www.isl.global](http://www.isl.global)